



Kerbey Lane Village

New Development on 35th

You may have been wondering what's happening with the houses on West 35th Street. This property is being redeveloped by Whit Hanks. Under an agreement with the Neighborhood Association, the zoning was changed from residential to commercial but with a limitation on the types of uses and intensity of development. To encourage preservation of the houses, the agreement requires a narrower scope of uses if the houses are removed.

Mr. Hanks' development will retain the houses, although (as you may have noticed) their locations on the property have changed. The agreement also stipulates that there will be no entrances or exits onto Kerbey Lane or the alley behind the project; therefore, traffic must enter and exit from West 35th Street.

The Neighborhood Association had discouraged prior inquiries by other parties to redevelop the property as a fast food location or strip shopping center, and appreciated the cooperative approach of Mr. Hanks.

- Michael Curry

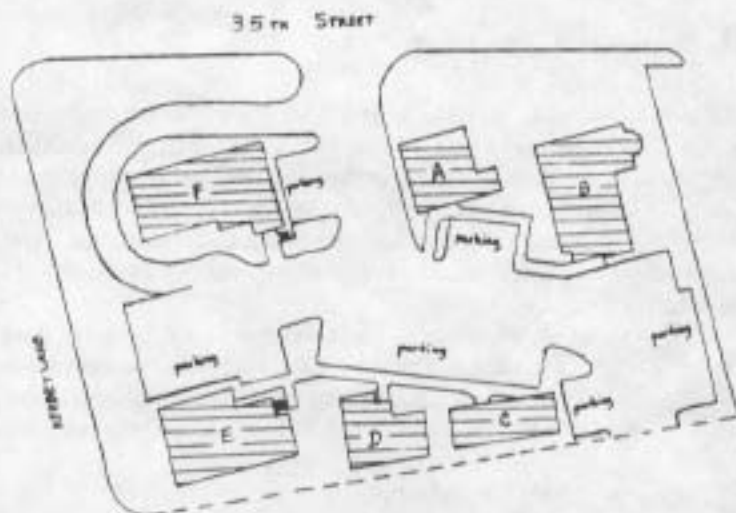

Who's at fault now? Bryker Woods: Earthquake Country

Did you know that a geologic fault zone passes directly through the Bryker Woods neighborhood? A fault is a fracture marked by displacement of the rock on the two sides. Rock does not break easily, and as the responsible force continues to intensify, the rock will "lock up" for a while, even if a fracture already had been established in that spot. Finally, an overwhelming buildup of force will rupture the fault again, temporarily relieving the stress. Each time this happens the rocks on either side of the fault are offset more, and there is an earthquake.

Fortunately, Austin is no longer Earthquake Country. All that excitement was millions of years ago, and today about all that happens is slow modification of the landscape by erosion.

The Bryker Woods fault is associated with a much larger fault that runs along the base of Mt. Bonnell on its east side, crossing Mt. Bonnell Drive under the bridge near the water treatment plant, and continuing across Lake Austin.

You can see the Bryker Woods fault by visiting the green belt west of St. Andrews School, where Shoal Creek is forced to jog to the east to get past a limestone cliff. As you stand on the deposit of coarse gravel, gaze up the hill past Shoal Creek, aligning your eyes parallel to the trend of the cliff. The cliff marks the plane of the fault, separating the hard rock on the left-hand side from the dark-colored, soft sediment that comprises the gentle slope on the right-hand side. A much thinner cliff made of the same limestone rests upon the soft sediment near the top of the hill. The base of the cliff up the hill on the right-hand side is equivalent to limestone at creek level on the left-hand side. Rock on the right-hand side was displaced upward about forty feet relative to the same stratum on the left-hand side.

-Dr. Leon E. Long, Professor of Geological Sciences, UT
(brought to our attention by one of our BWNA Board members, Bill Woods)

1996 BRYKER WOODS NEIGHBORHOOD ASSOCIATION MEMBERSHIP FORM

Attached is \$5 per household for membership in Bryker Woods Neighborhood Association.

Attached is \$_____ as a contribution to Bryker Woods Elementary School through BWNA and Adopt-A-School.

NAME(S) (please print)

ADDRESS

Please detach and mail or deliver to BWNA c/o Mr. David Boemisch / 1804 West 34th Set / Austin, TX 78703

School/Neighborhood Volleyball Court

Recently, BWNA donated \$345 to Bryker Woods School so the school could purchase volleyball equipment and net. Merrily Porter, current PTA President, wrote the Neighborhood Association, "Thank you so much for your recent donation to Bryker Woods Elementary. As you know, we are currently installing a sand volleyball court on our playground which our children will enjoy. Your donation will enable us to complete the court. We hope that the neighborhood residents will enjoy it, too! Thank you again for your generous assistance."

Happy Trails to You

Metropolitan Trails Council

Joyce Basciano has volunteered to be BWNA's representative to the Austin Metropolitan Trails Council (AMTC). The AMTC "is a local trail educational group committed to the development of a comprehensive, regional system of trails for the greater Austin metropolitan area. The Trails Council supports community-based trail and greenway proposals that provide commuting and recreational travel, protect natural resources, promote community cohesion and improve the quality of life in and around Austin."

The AMTC is sponsoring a National Trails Day Project on Saturday, June 7th at 9 a.m. at Zilker Park. The goal of this year's project is to repair damaged areas on Barton Creek Trail. Volunteers are needed to provide labor, publicity, food, and in-kind donations. Please call Mark Zahn at 835-8411 if you are interested in helping out.

Shoal Creek Greenbelt Coalition

In addition to the AMTC, there is the year-old Shoal Creek Greenbelt Coalition (SCGC), which has held several trail clean-up days, raised \$4000 for park improvements such as an information kiosk and trailside benches, conducted a greenbelt survey of 300 trail users, and educated trail users about responsible trail use. So far, most of SCGC's efforts have been focused south of 29th Street with an emphasis on the leash-free area for dogs and their owners. The SCGC would like support from neighborhoods bordering other stretches of the creek. The SCGC meets monthly near the kiosk. The next meeting will be June 15th at 4 p.m.

- Joyce Basciano

DON'T FORGET OUR BRYKER WOODS 4TH OF JULY PARADE - FLYERS ARE DISTRIBUTED ONLY ALONG THE PARADE ROUTE (KERBEY LANE AND GLENVIEW BETWEEN 30TH AND 34TH) BUT ALL THE NEIGHBORHOOD IS INVITED TO MEET AT 3300 KERBEY LANE ON FRIDAY THE 4TH AT 10:00 AM, COMPLETE WITH COSTUMES, DECORATED STROLLERS AND BIKES, PETS AND GUESTS. THE PARADE ROUTE IS SHORT ENOUGH TO GIVE US TIME FOR REFRESHMENTS AND VISITING, AND MEETING NEW NEIGHBORS AFTERWARDS. CALL SHIRLEY WILLIAMS AT 478-5509 TO OFFER HELP.

Neighborhood Association Officers and Board Members: President: Don Zappone (477-4395); Vice President: Irene Pickhardt (451-6820); Secretary: Alice McAfee (451-0785); Treasurer: David Boemisch (469-4572); Members At Large: Jerry Balaka (453-1072); Joyce Basciano (454-0207); Lisa & Michael Curry (453-7512); Betty Gross (453-3504); Susan Handy (480-0800); Matt Richter (480-0800); Tom Shefelman (477-9176); Barbara ten Brink (482-0532); Bill Woods (454-9180)

BWNA Dives In!

Your Neighborhood Association will join with the City of Austin to monitor the water quality of Shoal Creek. BWNA will become a Water Watchdog group, part of an effort started by the City in 1990.

After a June 6th training session, BWNA Board members Betty Gross and Joyce Basciano will take water samples on the first Firday of each month. Joining volunteers from across the city, they will conduct laboratory analyses that will give us information about the water quality of the creek and the health of the watershed.

Shoal Creek is important to our community. It collects runoff after rains, provides us with a beautiful recreational area, and helps the Bryker Woods area remain in balance by maintaining biological diversity. Where else in the neighborhood can you find turtles and blue egrets!

Results of the monitoring will be reported in future issues of this Newsletter.

If you want to get involved in this effort, call Michele Blair with the City of Austin at 499-2088 or contact members of the BWNA Board.

- Irene Pickhardt

New Board Secretary

Due to the recent ill health of long-time BWNA Secretary Rachel Kolberg (one of the founders of the Neighborhood Association in 1983), the position of Secretary on the Board became vacant. At a recent meeting of the Officers and Board, Alice McAfee graciously agreed to serve in this position.

Thank you, Rachel, for your many years of service and we welcome Alice to the Board.

Friends may reach Rachel at Gracy Woods II, 12042 Bittern Hollow, Austin 78758.